



PROMOTECH[®]

PRO-76 | INDUSTRIAL DRILLING MACHINE

PRO-76 is multifunction drill with Morse Taper No. 3.

The drill is equipped with motor overload protection system, electronic speed control, Electronic Speed Stabilization System (ESSS) – responsible for stabilizing motor's speed under varying loads on the spindle.

PRO-76 precision and durability are significantly increased thanks to integrated gearbox housing with slide.

Unique semi-automatic gib adjustment system (patent pending) enables simple, fast and always correct fine tuning without any expert knowledge or experience.

Replaceable spline at the end of armature shaft eliminates laborious and expensive armature maintenance.

PRO-76 is also equipped with electromagnetic base featuring magnetic field shape control system (MFSC) and magnetic power adhesion control module (MPAC), which detects adhesive force of electromagnetic base and protects both the machine and the operator from work on too thin workpieces.

Standard shipping set of PRO-76 includes MT3 Arbor with 19 mm (3/4") Weldon Bore that accepts cutters up to 60 mm diameter. Optional MT3 Arbor with 32 mm (1-1/4") Weldon Bore for cutters of larger diameters is available.

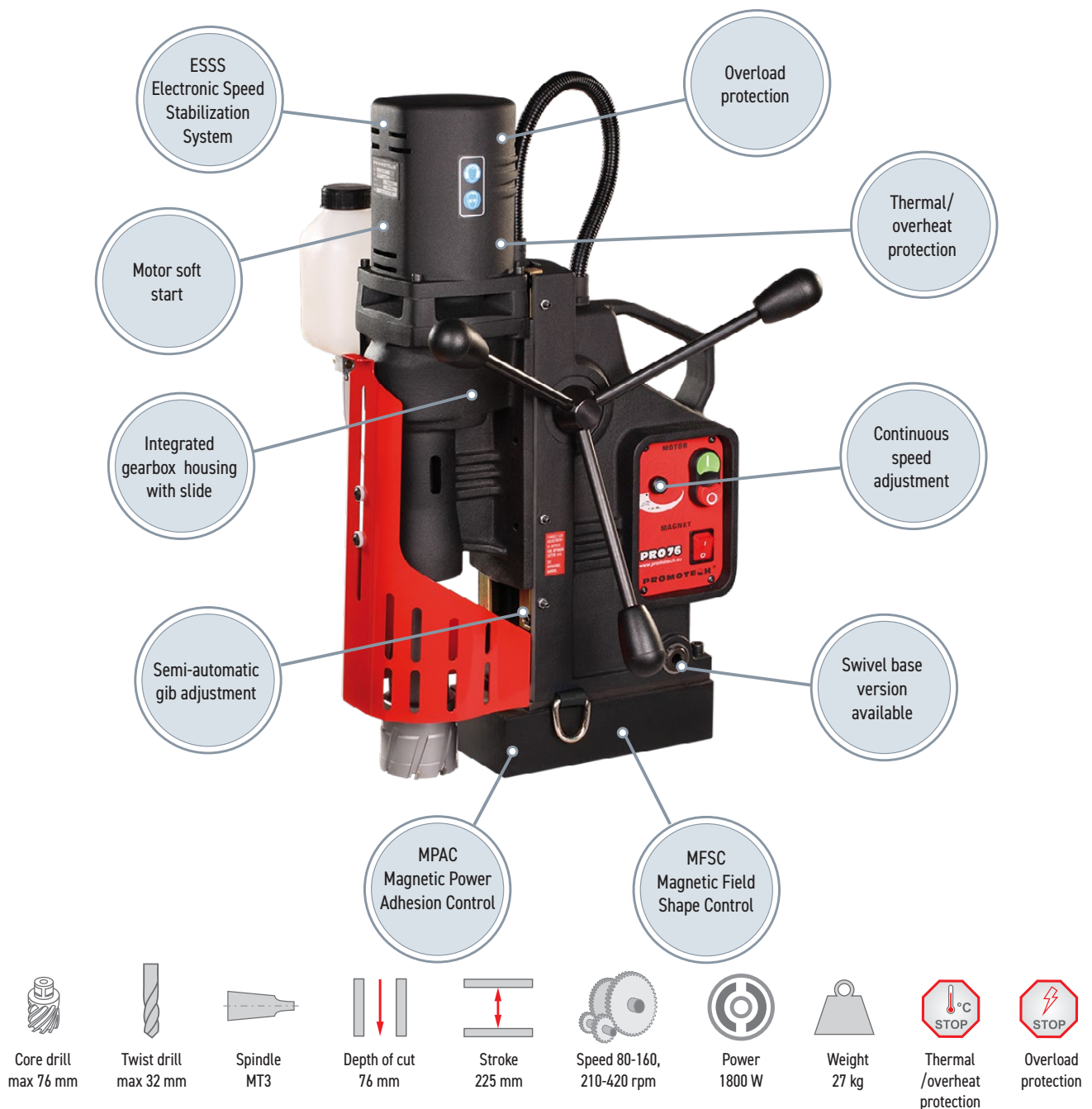



PRO-76 TECHNICAL SPECIFICATION	
Motor Speed (under load)	80÷160; 210÷420 rpm
Power	1800 W
Weight	27 kg (58 lbs 4 oz)
Max milling capacity	76 mm (3")
Max drilling capacity	32 mm (1-1/4")
Max countersinking	63 mm (2-1/2")
Max tap size	M24 (tapping attachment required)
Stroke	225 mm (8-7/8")
Max depth of cut	76 mm (3")
Voltage	1~ 110-120 V, 50-60 Hz 1~ 220-240 V, 50-60 Hz
Overload protection	yes
Thermal/overheat protection	yes
ESSS (Electronic Speed Stabilization System)	yes
Continuous speed adjustment	yes
Semi-automatic gib adjustment	yes
MPAC (Magnetic Power Adhesion Control)	yes
MFSC (Magnetic Field Shape Control)	yes
Magnetic clamping force	1988 kgf (19500 N) /25 mm, Ra=1,25/
Magnet Base Dimensions	110 x 220 x 56 mm 4-5/16 x 8-11/16 x 2-3/16 (")
Min. Workpiece Thickness	10 mm (3/8")
Swivel base (PRO-76+ only)	±15°; ±15 mm (± 9/16")
Spindle	MT3
Tool holder	19mm (3/4") or 32mm (1-1/4") Weldon
Product Code 220-240 V, 50-60 Hz	WRT-0400-10-20-00-0
Product Code 110-120 V, 50-60 Hz	WRT-0400-10-10-00-0

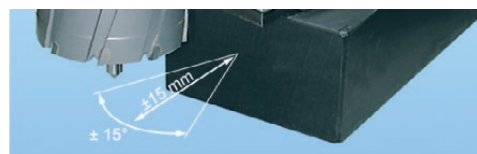

Swivel base in version PRO-76+

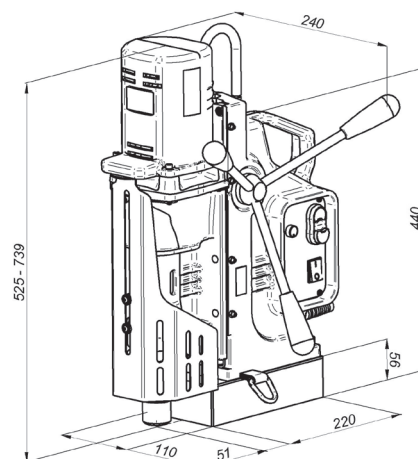

Standard shipping set:

- Magnetic Base Drilling Machine
- Metal Box
- MT3 Arbor with 19 mm Bore - Through Spindle Continuous Cooling
- Swarf Shield/Cutter Guard
- Coolant Bottle Assembly, Safety Chain with Snap Hook, Set of Tools with Wedge
- Operator's Manual
- Standard shipping weight - 40 kg (86 lbs 5 oz)

Selected additional accessories:

- UCW-0191-00-00-00 Through Spindle Continuous Cooling Arbor MT3-32 Weldon Bore
- UCW-0285-03-00-02-0 Quick Change Continuous Cooling Arbor MT3- 19 Weldon
- PDS-0111-03-00-01-0 DMP0501 Pipe Attachment



Kilkeny Welding Supplies LTD.
Cuffesgrange, Co.Kilkeny PH (056) 7729949
Portlaoise, Co.Laois PH: (057) 8621479
info@kws.ie www.kws.ie